



CE 2934



For self-testing Novel Coronavirus(SARS-Cov-2) Antigen Rapid Test Device(saliva)



Features:

- ✓ Specimen types: Saliva
- ✓ Sensitivity: >95.38%
- ✓ Testing time: 10-15minutes
- ✓ Specificity: >99.9%

REALTECH
Novel Coronavirus (SARS-Cov-2)
Antigen Rapid Test Device (saliva)
For self-testing (REF) K590516D
This kit is intended for the qualitative detection of the N protein of SARS-Cov-2 antigens in human saliva specimens.
Components
• 1 Test Device • 1 Saliva collection cap/bag • 1 Nozzle • 1 Sample Extraction Buffer
• 1 Extraction Tube • 1 Biohazard Specimen Bag • 1 Dropper • 1 Package Insert

Accurate Fast Easy

1 Test

ACCURATE

FAST

EASY

VOV TRADE s.r.o.
www.vovtrade.com

New

Saliva



- Collection of specimens is less technically complex, ensure self-collection and quick collection
- Less patient discomfort
- Less or no aerosol generation

Applications

SELF-TEST

(If permitted by local regulation)

- Self-collection of specimen.
- Simple operation, can be self-performed at home or other Places.

Directions for use

1

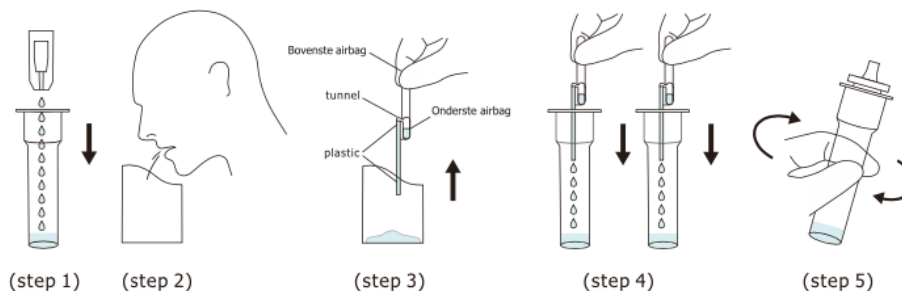

2

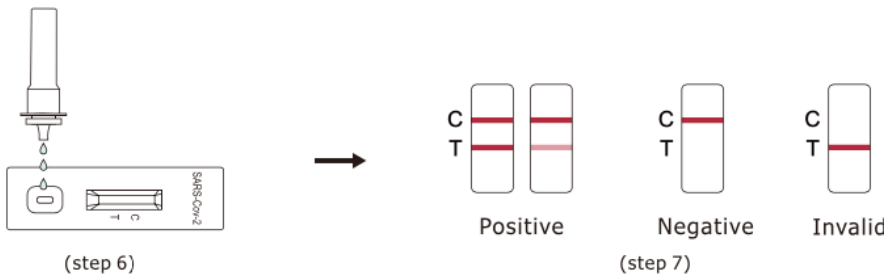

Product information

Product name	Ref.	Size	Storage Temp
Novel Coronavirus(SARS-Cov-2) Antigen Rapid Test Device(saliva)	K590516D	1 Test/kit	2-30 C
Packing Details: 500 pcs/carton Carton Size (cm): 73*49*43 Nett Weight (KG): 19. Gross Weight (KG): 20 EAN BAR Code: 6971792050068			